

FOR LEASE



9198  
COMMERCIAL  
STREET

NEW MINASINS



# FOR LEASE



## 9198 COMMERCIAL STREET, NEW MINAS | NS

Located along the busy Commercial Street corridor, this retail/professional services plaza neighbors the Country Fair Mall in the heart of the New Minas business district. It is centrally located within walking distance to all amenities. Ample off-street parking available and great store front visibility.

Current available units range between 1,283 to 2,245 sq. ft., an ideal location for retail or office.

### PROPERTY FEATURES



SURROUNDED BY MANY RETAILS AND RESTAURANTS



GREAT VISIBILITY AND EXPOSURE



SIGNAGE OPPORTUNITY



UNITS CAN BE COMBINED



AMPLE ON-SITE PARKING

### CONTACT

ANDREW WHIDDEN  
LEASING COORDINATOR  
902.894.4729 EXT. 238  
[LEASING@THEGRAYGROUP.CA](mailto:LEASING@THEGRAYGROUP.CA)

# FOR LEASE

## 9198 COMMERCIAL STREET, NEW MINAS | NS

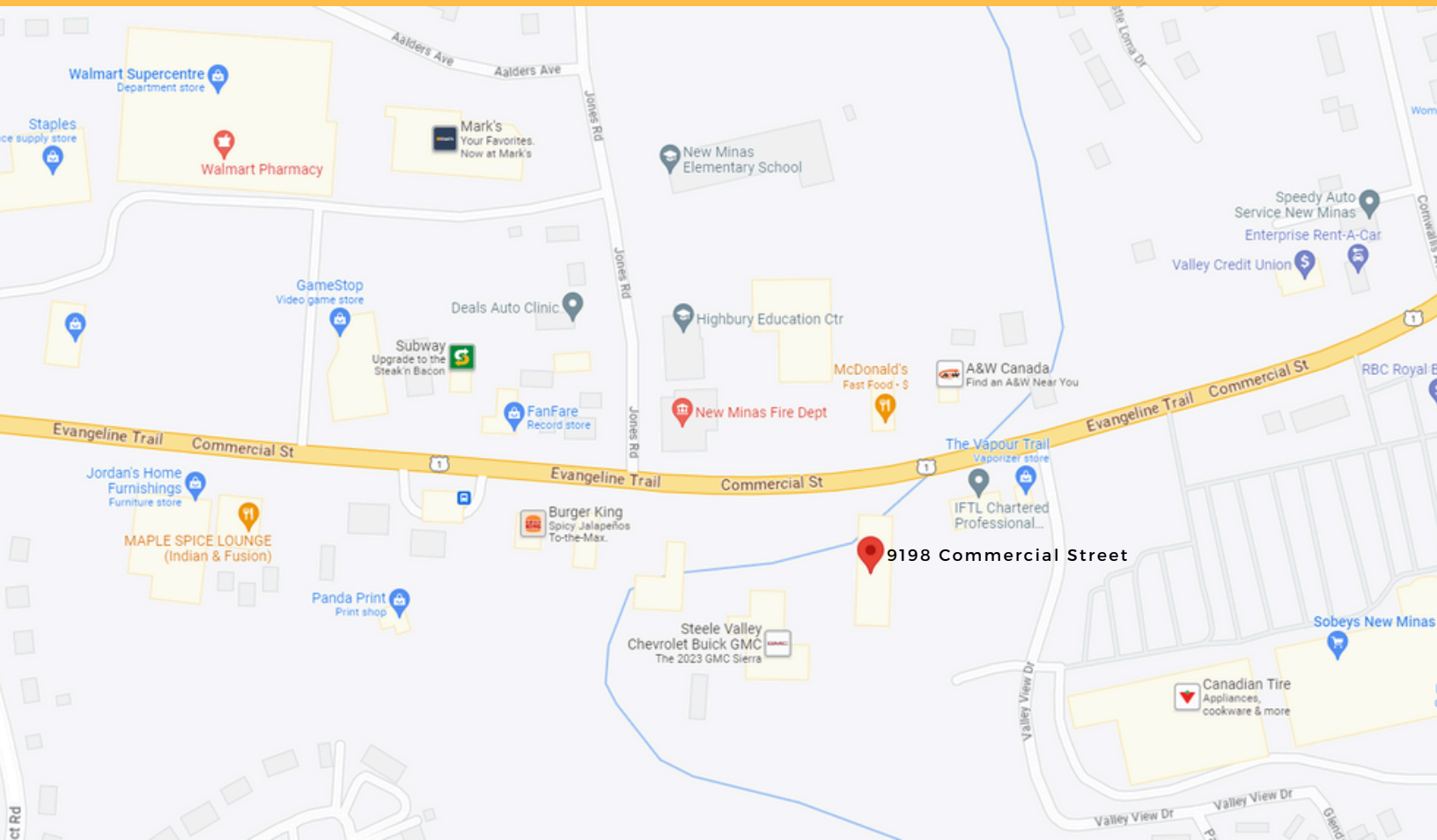

## LOCATION INFORMATION

Located on the main thoroughfare of Commercial Street/Evangeline Trail, with only a few minutes drive to Country Fair Mall. The property can be accessed directly from Commercial Street or from Valley View Drive on the site's Eastern boundary. The surrounding area offers an excellent selection of amenities including restaurants and retail stores.

## CONTACT

ANDREW WHIDDEN  
LEASING COORDINATOR  
902.894.4729 EXT. 238  
[LEASING@THEGRAYGROUP.CA](mailto:LEASING@THEGRAYGROUP.CA)

20 GREAT GEORGE STREET, CHARLOTTETOWN, PE C1A 4J6

902.894.4729 | [THEGRAYGROUP.CA](http://THEGRAYGROUP.CA)



**FOR LEASE**

**9198 COMMERCIAL STREET, NEW MINAS | NS**

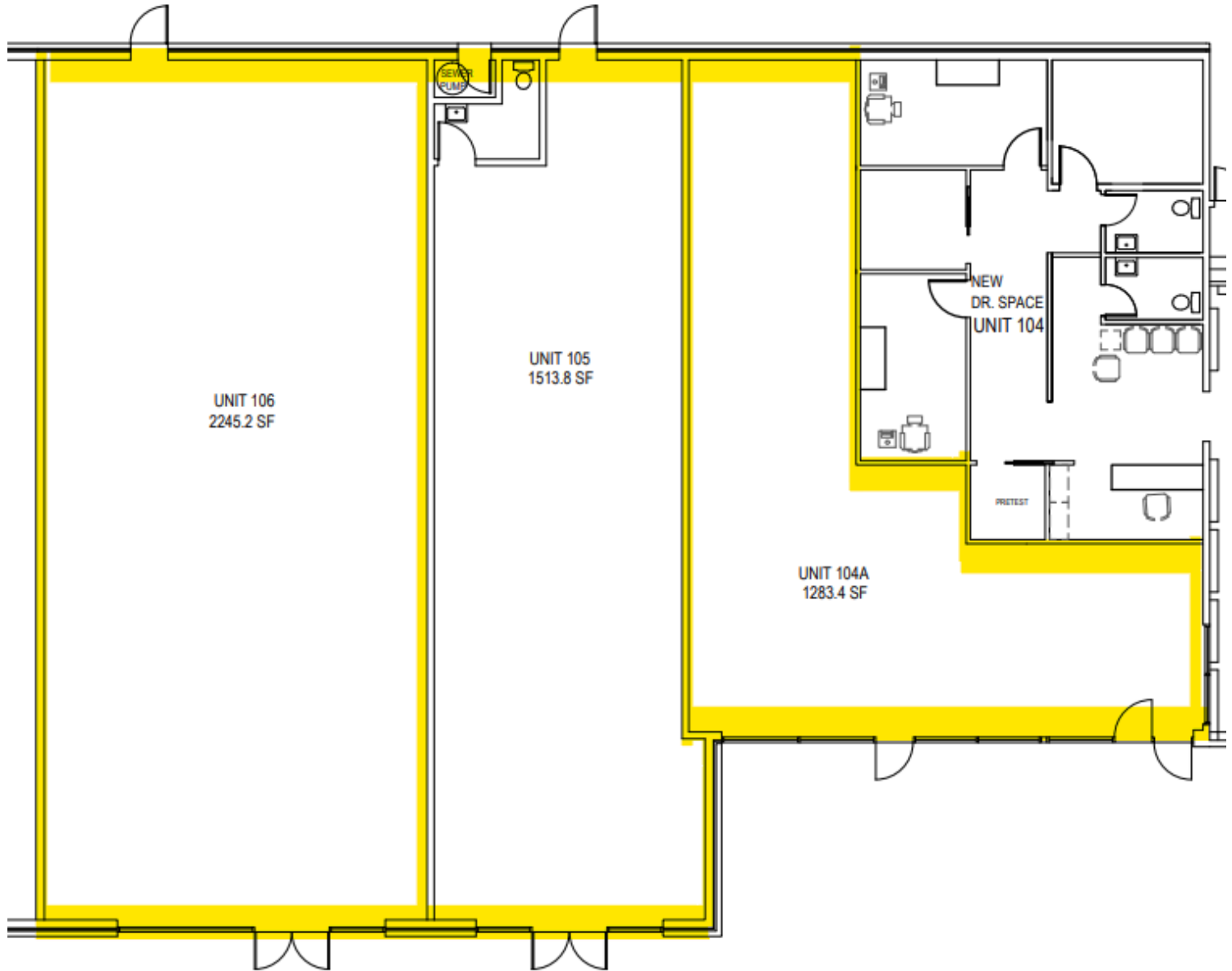

## AVAILABLE UNITS FLOOR PLAN

### CONTACT

ANDREW WHIDDEN  
LEASING COORDINATOR  
902.894.4729 EXT. 238  
[LEASING@THEGRAYGROUP.CA](mailto:LEASING@THEGRAYGROUP.CA)

20 GREAT GEORGE STREET, CHARLOTTETOWN, PE C1A 4J6

902.894.4729 | [THEGRAYGROUP.CA](http://THEGRAYGROUP.CA)



**FOR LEASE**

**9198 COMMERCIAL STREET, NEW MINAS | NS**



**CONTACT**

ANDREW WHIDDEN  
LEASING COORDINATOR  
902.894.4729 EXT. 238  
[LEASING@THEGRAYGROUP.CA](mailto:LEASING@THEGRAYGROUP.CA)