

FOR LEASE



9198
COMMERCIAL
STREET

NEW MINASINS



FOR LEASE



9198 COMMERCIAL STREET, NEW MINAS | NS

Located along the busy Commercial Street corridor, this retail/professional services plaza neighbors the Country Fair Mall in the heart of the New Minas business district. It is centrally located within walking distance to all amenities. Ample off-street parking available and great store front visibility.

Current available units range between 1,514 to 2,348 sq. ft., an ideal location for retail or office.

PROPERTY FEATURES



SURROUNDED BY MANY RETAILS AND RESTAURANTS



GREAT VISIBILITY AND EXPOSURE



SIGNAGE OPPORTUNITY

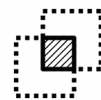

UNITS CAN BE COMBINED



AMPLE ON-SITE PARKING

CONTACT

ANDREW WHIDDEN
LEASING COORDINATOR
902.894.4729 EXT. 238
LEASING@THEGRAYGROUP.CA

FOR LEASE

9198 COMMERCIAL STREET, NEW MINAS | NS

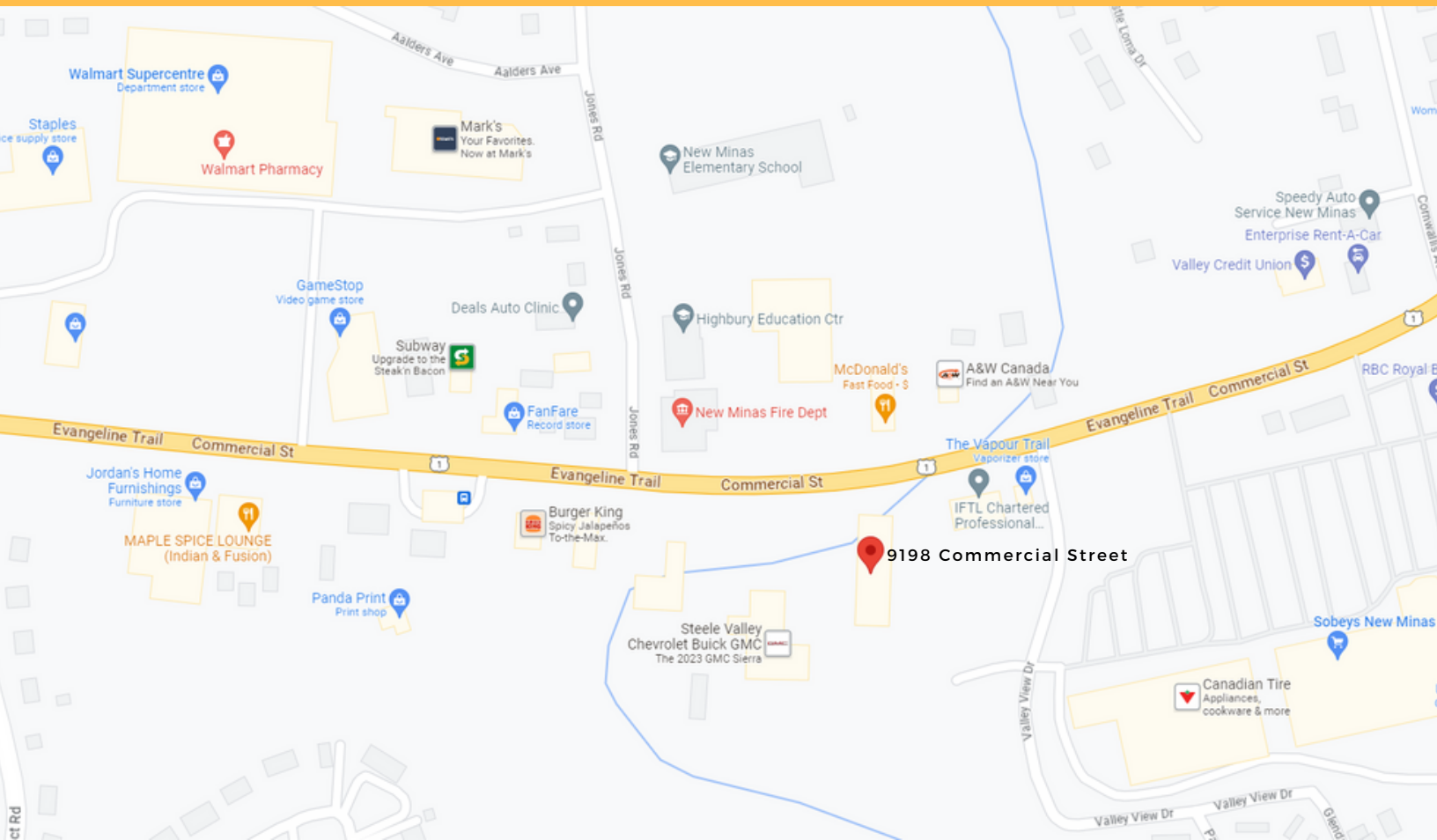

LOCATION INFORMATION

Located on the main thoroughfare of Commercial Street/Evangeline Trail, with only a few minutes drive to Country Fair Mall. The property can be accessed directly from Commercial Street or from Valley View Drive on the site's Eastern boundary. The surrounding area offers an excellent selection of amenities including restaurants and retail stores.

CONTACT

ANDREW WHIDDEN
LEASING COORDINATOR
902.894.4729 EXT. 238
LEASING@THEGRAYGROUP.CA

20 GREAT GEORGE STREET, CHARLOTTETOWN, PE C1A 4J6

902.894.4729 | THEGRAYGROUP.CA



FOR LEASE

9198 COMMERCIAL STREET, NEW MINAS | NS

ELECT. RM.
(BASE BUILDING)

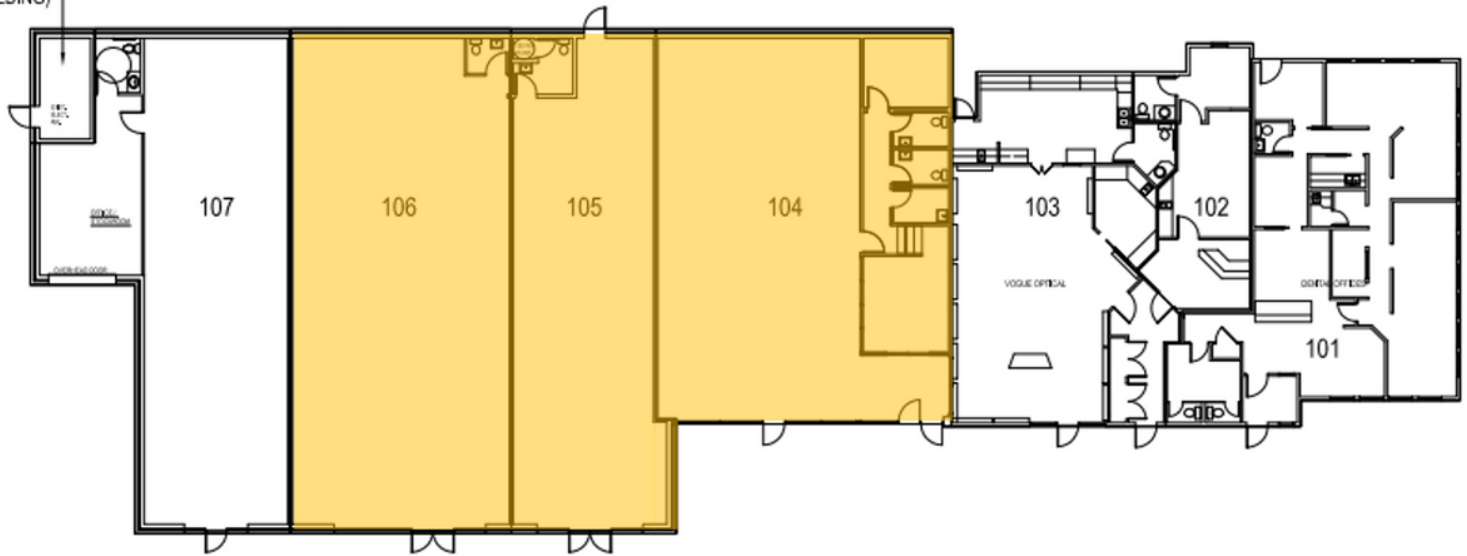

TENANT SPACE

101 = 1,646 S.F.

102 = 501 S.F.

103 = 1,471 S.F.

104 = 2,348 S.F.

105 = 1,514 S.F.

106 = 2,245 S.F.

107 = 1,968 S.F.

BASE BUILDING = 148 S.F.

TOTAL AREA = 11,840 S.F.

9198 COMMERCIAL ST.
NEW MINAS, NS

AVAILABLE UNITS FLOOR PLAN

CONTACT

ANDREW WHIDDEN
LEASING COORDINATOR
902.894.4729 EXT. 238
LEASING@THEGRAYGROUP.CA

20 GREAT GEORGE STREET, CHARLOTTETOWN, PE C1A 4J6

902.894.4729 | THEGRAYGROUP.CA



FOR LEASE

9198 COMMERCIAL STREET, NEW MINAS | NS



CONTACT

ANDREW WHIDDEN
LEASING COORDINATOR
902.894.4729 EXT. 238
LEASING@THEGRAYGROUP.CA

20 GREAT GEORGE STREET, CHARLOTTETOWN, PE C1A 4J6
902.894.4729 | THEGRAYGROUP.CA

